

**Top of Tank Line, Plastics Type: 25271/10 PVDF**

Design meets the requirements of PED 97/23/EC and harmonized standards

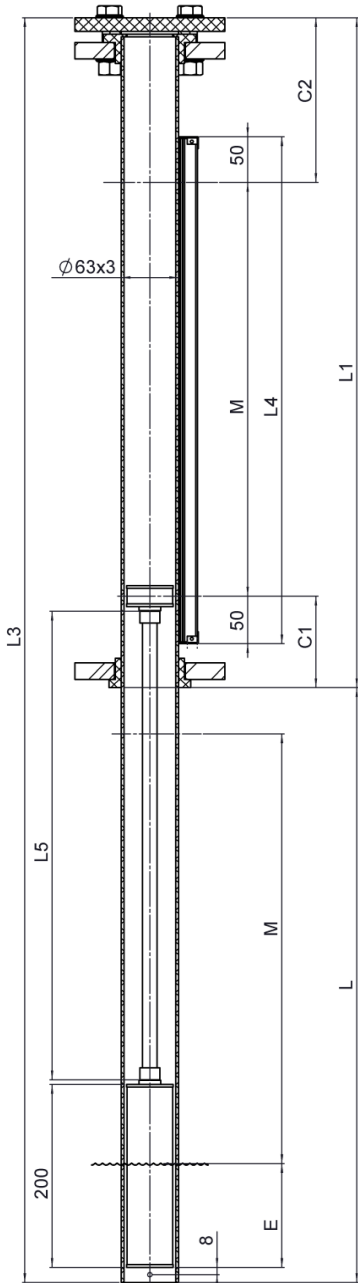

**Purchase Order Data**

Company: \_\_\_\_\_ Project: \_\_\_\_\_  
 Purchase order No.: \_\_\_\_\_  
 Quantity: \_\_\_\_\_ Tag No.: \_\_\_\_\_

**Operating Conditions**

Fluid: \_\_\_\_\_  
 Density:  $\geq 0.87\text{g/cm}^3$  g/cm3: \_\_\_\_\_  
 Viscosity:  $\leq 600\text{cSt}$  cSt: \_\_\_\_\_  
 Operation pressure: max. 10bar(g) @20°C \*1) bar(g): \_\_\_\_\_  
*Design pressure:* " bar(g): \_\_\_\_\_  
 Operation temperature: -20°C ... +140°C \*1) °C: \_\_\_\_\_  
*Design temperature:* " °C: \_\_\_\_\_  
 Gaskets for top service connection: FKM

**Process Connections**

- Connection dimension acc. EN1092 : 2013**  
 - EN1092-1/02 A/DN50/PN16/PP-V (t < 80°C) \_\_\_\_\_  
 - EN1092-1/02 A/DN50/PN16/316L \_\_\_\_\_  
 - Collar bushing, sealing surface grooved
- Connection dimension acc. ASME B16.5:2013**  
 - ANSI/ASME B16.5/2"cl.150/PP-V (t < 80°C) \_\_\_\_\_  
 - ANSI/ASME B16.5/2"cl.150/316L \_\_\_\_\_  
 - Collar bushing, sealing surface grooved

**Special flange execution**

\_\_\_\_\_

**Dimensions**

- Tank depth L  
 Length L1 (M + 280 mm)  
 C1  
 C2  
 Measuring length M (L - 200 mm)  
 Length L4 (M + 100 mm)  
 Connection pipe length L5  
 Immersion depth E

**Standard**

0
100
180
0
0
0
-

**Special**

0
0
0
0
-

\_\_\_\_\_

**Design and Materials**

Float chamber: PVDF  
 Float: \_\_\_\_\_  
 Magnet holder: Standard ( 29601 ) \_\_\_\_\_

**Indication Rail**

PC, IP65 (<150°C)	Flaps: red-silver	No.: 34837	Standard
PC, IP68, inert gas (<150°C)	Flaps: red-silver	No.: 41008	
Al/PC, IP54 (<250°C)	Flaps: red-silver	No.: 34560	
Al/Glass, IP54 (<400°C)	Flaps: black-silver	No.: 37100	
316L, IP67 (<250°C)	Flaps: red-silver	No.: 42403	
316L, IP67 (<400°C)	Flaps: black-silver	No.: 42404	
Special execution	Flaps: _____	No.: _____	

**Float Extension bottom / top**

	C1:	C2:
Standard	100	180

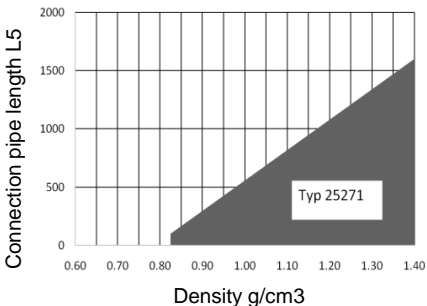

**Accessories (refer to installation instructions 20010501)**

Reinforcement pipe D68x1.5mm: \_\_\_\_\_  
 Fixation bracket No. 26936: \_\_\_\_\_ Dim. "A" [mm]: \_\_\_\_\_  
 Magnetic switch: Quantity: \_\_\_\_\_ Type: \_\_\_\_\_  
 Transmitter: Resolution [mm]: \_\_\_\_\_ Type: \_\_\_\_\_  
 Electrical measuring length Mel [mm]: \_\_\_\_\_  
 Converter: Type: \_\_\_\_\_  
 Additional accessories: \_\_\_\_\_

**Special Executions & Additional Notes**

\_\_\_\_\_

**Notes**

\*1) Refer to pressure-temperature rating! Lowest rating of any connecting flange or fitting and float chamber sets the limitation.  
 The test pressure PT is specified acc. to WEKA specifications AW 2.1.2.

All mentioned dimensions are in mm and are valid only for ToT standard executions.

## Pressure-temperature rating for Top of Tank Plastic, 25271/PVDF

Max. 10bar(g)@20°C, up to max.140°C for ToT float chambers in PVDF

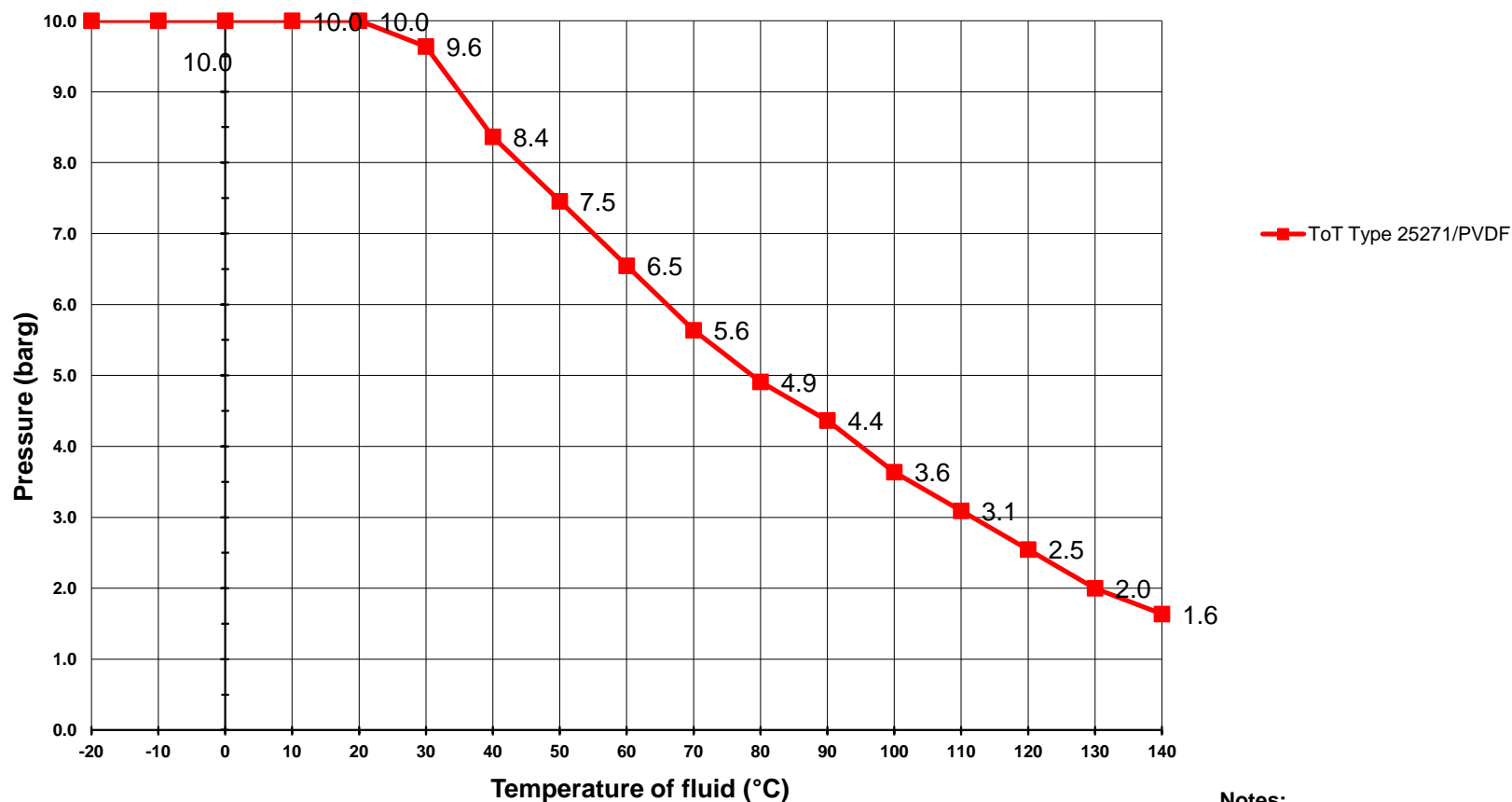

**Notes:**

The indicated values are for an estimated use of maximum 25 years. The values were determined for water or water-like media only. No reduction factor for other chemicals has been used. When using media with possible additional wear the lifetime may be reduced accordingly.

Operating range

AINiCo Magnet
NBR gasket
PC indication rail
Al or SS standard indication rail
Al oder SS high temperature indication rail
SS screws and nuts in A2-70